



Greycoat Place, SW1P | £3,000 Per Month



TUCKERMAN
ESTATE AGENTS
PROPERTY PROFESSIONALS

Greycoat Place, St James's Park, SW1P

Bright and spacious, well presented two bed, two bath property located on the top floor of this modern development in Westminster. Lift access and furnished. Available from the 5th August 2025.

ACCOMODATION

The property extends over 880sq ft and comprises; two double bedrooms, large open-plan living area, fully fitted kitchen and two bathrooms. Lift access to the top floor. Fully furnished. Parking can be available through separate negotiation and subject to availability.

LOCATION

The location is convenient for the many local amenities of Victoria Street such as Cardinal Place and within comfortable walking distance are Victoria, Westminster and St James's Park stations.

COUNCIL TAX





Greycoat Place, St James's Park, SW1P

Let

Per Month: £3,000 Per Month

Furnishing: Furnished

Available From: 5th August 2025

Local Authority: Westminster City Council

Council Tax Band: F

Approximate Gross Internal Area:
899.00 sq ft

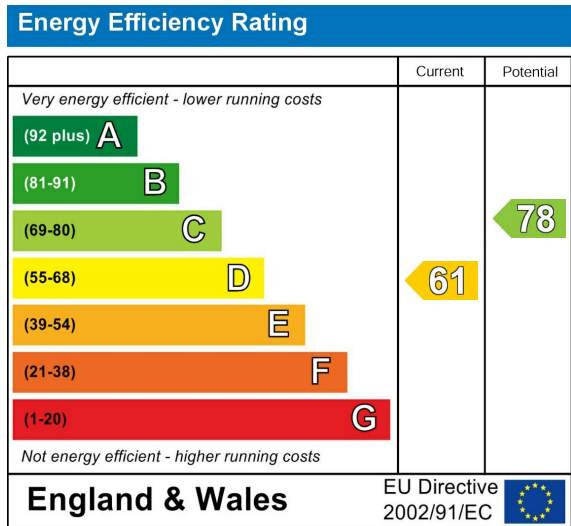

GREYCOAT PLACE
LONDON SW1

Gross Internal Area: 84 Sq. metres
899 Sq. feet

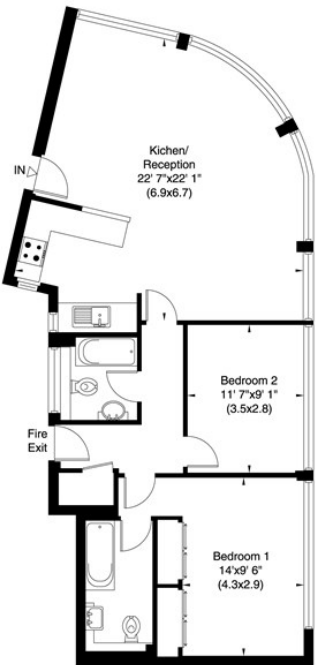

Sixth Floor

Not to scale, for guidance only and must not be relied upon as a statement of fact. All measurements and areas are approximate only (and have been prepared in accordance with the current edition of the RICS Code of Measuring Practice).

Floor Plan by capital group 020 8671 7722

Agents Note: Whilst every care has been taken to prepare these sales particulars, they are for guidance purposes only. All measurements are approximate are for general guidance purposes only and whilst every care has been taken to ensure their accuracy, they should not be relied upon and potential buyers are advised to recheck the measurements